

Lahore Rapid Mass Transit System (RMTS) Masterplan and Feasibility Studies



The second largest town of Pakistan and the capital of the Punjab has more than 9 million inhabitants in the metropolitan area. The population and the economy have grown rapidly and the transport demand have increased to reach a 13.5 million daily passengers trips made by all modes of transportation. Lahore started planning and prioritizing corridors for its metro network in the early 1990s. In 2005, the Government of Punjab Transport Department commissioned MVA Asia Ltd. to conduct an updated masterplan study and four corridors were identified. MVA was then commissioned to undertake full feasibility studies for the first two priority lines. In addition, a feasibility study of an elevated ring road was being conducted in parallel.

Scope of work:

Lahore RMTS Feasibility Study:

- ▶ Reviewed Transport network
- ▶ Conducted forecast modeling
- ▶ Identified priority corridors for RMTS
- ▶ Conducted all aspects to feasibility study for RMTS which included:
 - Traffic studies
 - Economic component
 - Financial studies

RMTS overall network & Green and Orange Lines Feasibility Studies included:

- ▶ Transport Masterplan studies RMTS
- ▶ Patronage and revenue forecasting and analysis
- ▶ Engineering and systems design and costing
- ▶ Economic and financial

assessments

- ▶ Traffic impact studies
- ▶ Civil and structural design (for tender process and design build/implementation phase)
- ▶ Cost estimates

Facts and figures on first implemented segment:

Green line/ Ferozepur Road Corridor

- ▶ Length: 27 km (11.6 km tunnels, 15.4 viaducts)
- ▶ Number of stations: 22 (12 underground and 10 elevated)
- ▶ Number of depot: 2
- System type: Steel Rails driverless

Orange Line

- ▶ Line runs between Dera Gujran (north-east) to Ali Town (south-west)

Facts and Figures on Overall Metro network:

- ▶ 4 lines
- ▶ 97 km
- ▶ 82 stations
- ▶ Station platforms: 102 m long
- ▶ Fleet of 54 trains (4 to 6 cars each)
- ▶ 1028 passenger capacity per train
- ▶ Approximately 2 min. headways
- ▶ Driverless trains
- ▶ Operated thru Operation Controlled Center

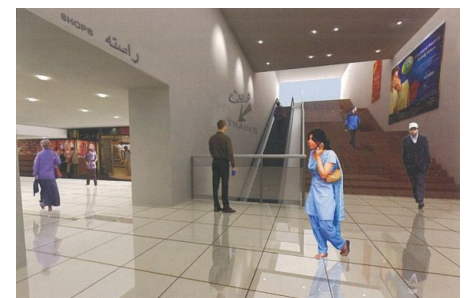
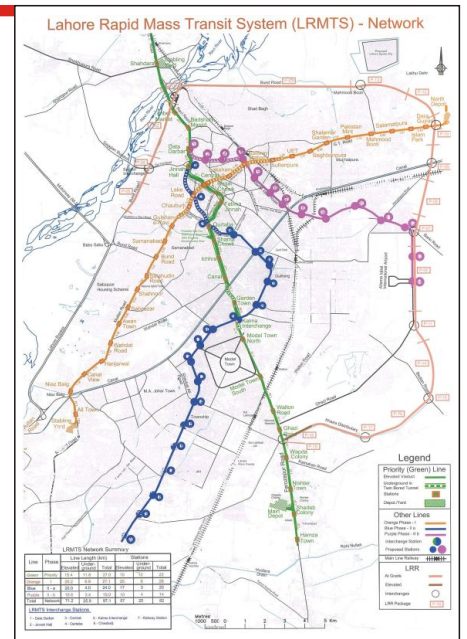

MVA Head Office in Asia

26/F China Resources Building
26 Harbour Road
Wanchai Hong Kong

Tel : (852) 2529 7037
Fax : (852) 2527 8490
mva@mva.com.hk
www.mvaasia.com

