

Kolkata International Convention Centre



Kolkata, the capital of West Bengal, is situated at the eastern extremity of the vast, flat Indo-Gangetic plain in India. It is one of the largest metropolises in the world and has a population of over 10 million. MVA was appointed to provide Masterplan advice and conduct a traffic study of this major international Convention Centre.



Working closely with the project architects, MVA provided advice concerning parking and servicing requirements and layouts using our database of international standards and survey data to derive volumes for both that were practical and sustainable in an environment of increasing car ownership and taking into consideration the demand for improved public transport.

MVA also advised on the internal circulation for each part of the development : the Convention

Centre, 4 hotels, extensive retail and office developments plus a large residential development. A major concern was to ensure adequate access to the site and, as far as practical, independent circulation for the visitors to the individual components of the development.

MVA also provided advice concerning pedestrian and public transport accessibility.



The second stage of MVA's commission was to conduct a transport study of the development including sizing the immediately adjacent intersections for use in discussions with the local Government to ensure that the development was accessible in the future as developments in the vicinity were completed and occupied.

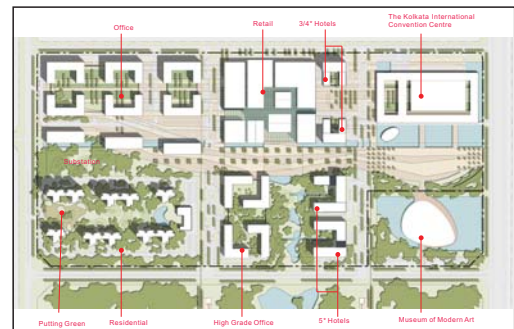
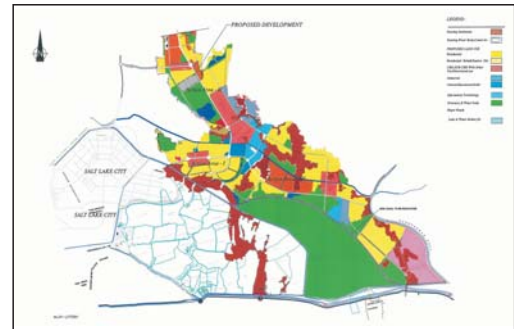

Kolkata International Convention Centre

Convention Centre GFA	: 46,000 sqm
Residential GFA	: 124,000 sqm
Office GFA	: 260,000 sqm
Retail GFA	: 120,000 sqm
Hotel GFA	: 57,000 sqm

Note :
The above quoted figures are indicative only.

MVA Head Office in Asia

26/F China Resources Building
26 Harbour Road
Wanchai Hong Kong

Tel : (852) 2529 7037
Fax : (852) 2527 8490
mva@mva.com.hk
www.mvaconsultancy.com

